

Ansamblu S1 - 2 buc.
scara 1:20

P1 - HEA260
L=7250 - 1 buc.
scara 1:20

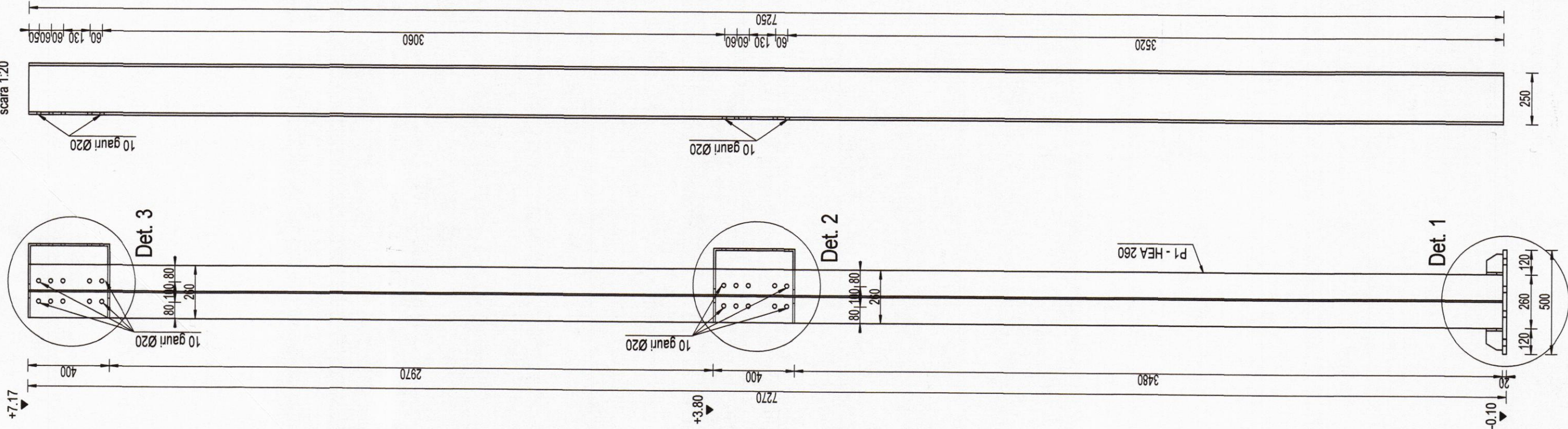

Detaliu 3
scara 1:10

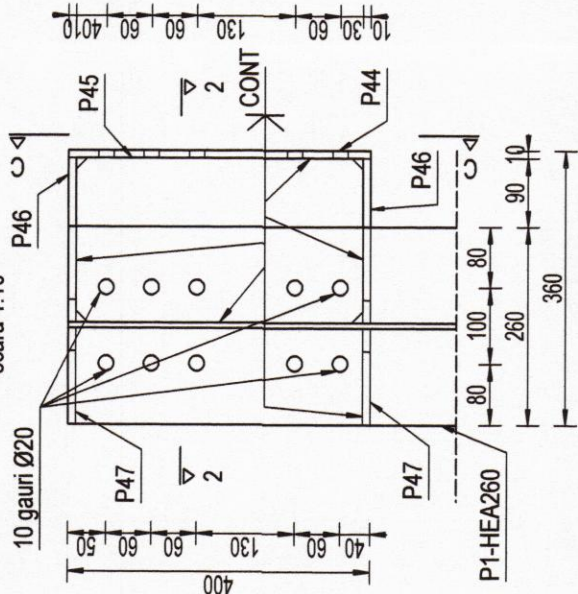

Vedere C - C
scara 1:10

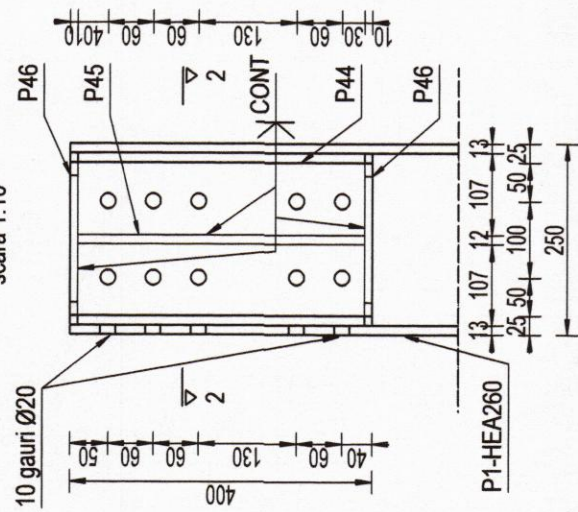

Detaliu 2
scara 1:10

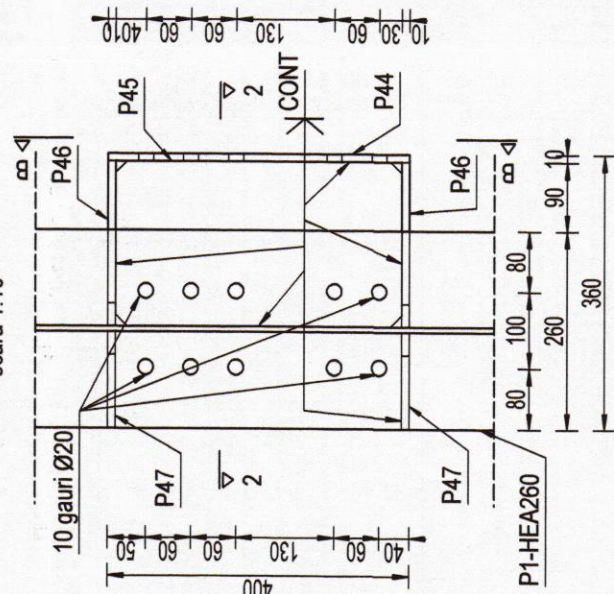

Vedere B - B
scara 1:10

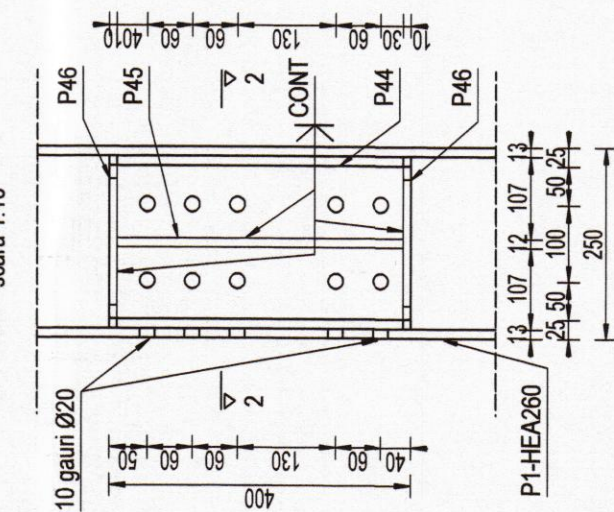

Detaliu 1
scara 1:10

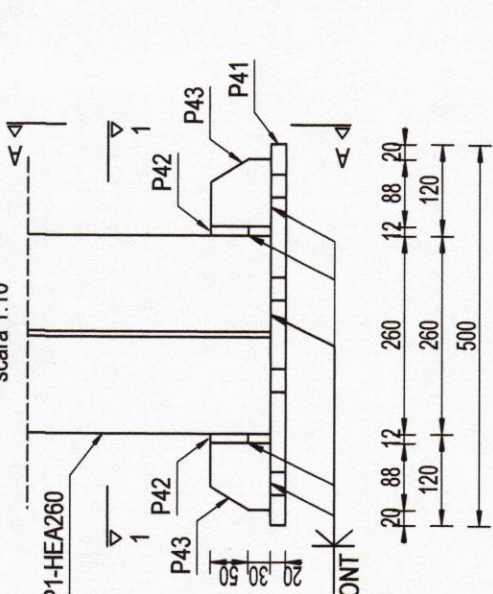

Vedere A - A
scara 1:10

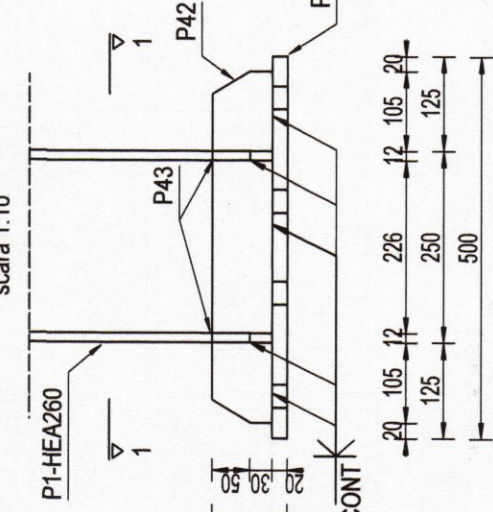

Sectiune 1 - 1
scara 1:10

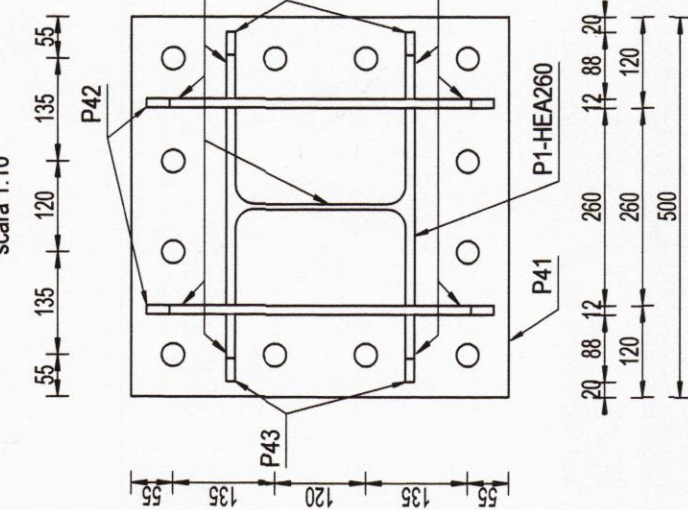

Sectiune 2 - 2
scara 1:10

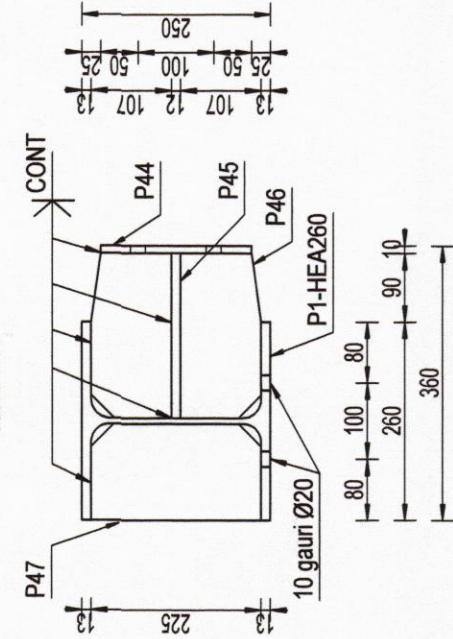

P41 - 1 buc.
tg. 20x500-500
scara 1:10

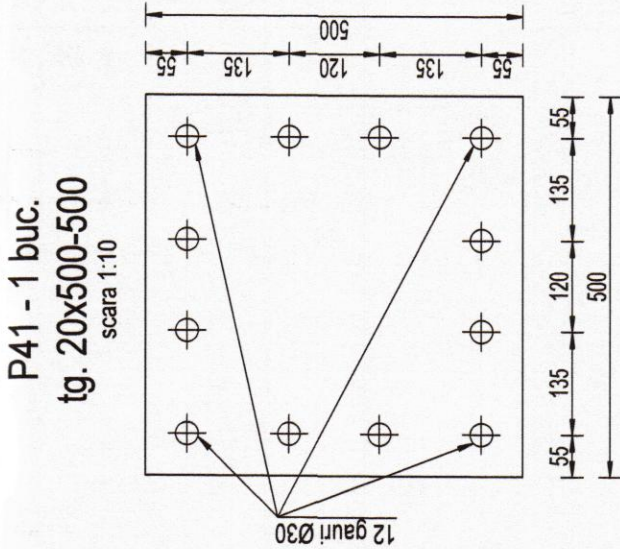

P44 - 2 buc.
tg. 10x200-400
scara 1:10

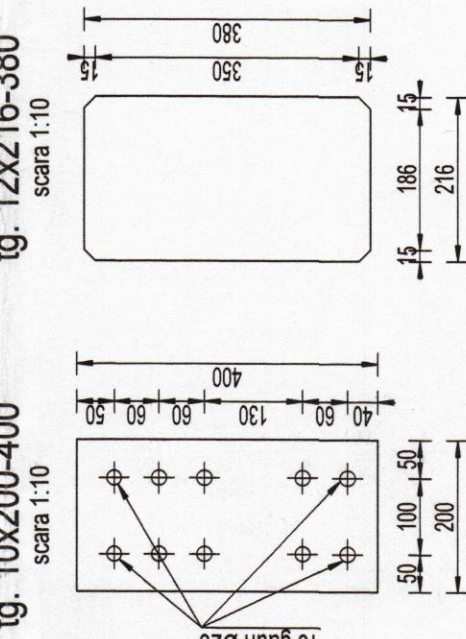

P45 - 2 buc.
tg. 12x216-380
scara 1:10

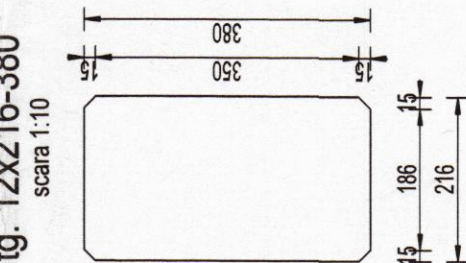

P46 - 4 buc.
tg. 10x216-225
scara 1:10

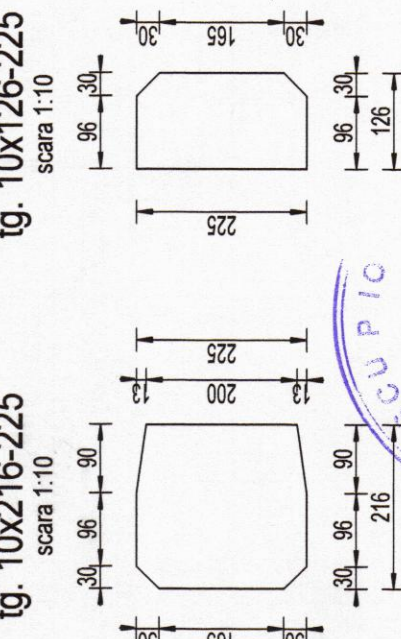

P47 - 4 buc.
tg. 10x126-225
scara 1:10

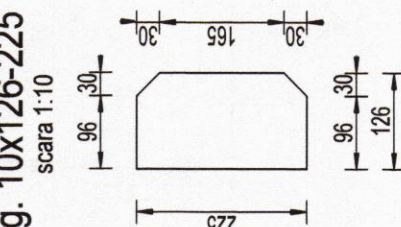

P43 - 4 buc.
tg. 12x80-88
scara 1:10

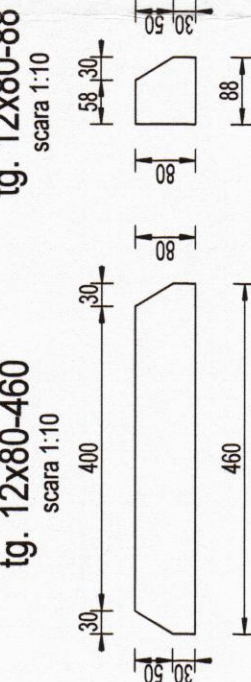

P42 - 2 buc.
tg. 12x80-460
scara 1:10

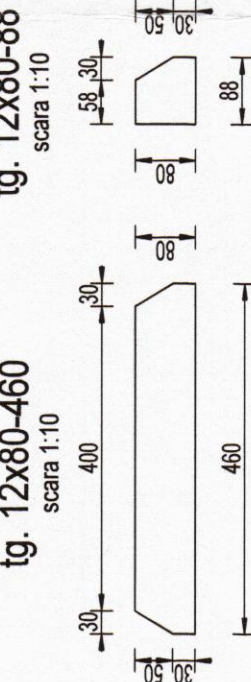

EXTRAS DE LAMINATE					
Pozitie	Denumire	Grosime (mm)	Lungime (mm)	Nr. Buc	Nr. Elem
P1	HEA-260		7250	1	2
P41	tg. 20x500-500	20	500	1	2
P42	tg. 12x80-460	12	80	460	2
P43	tg. 12x80-88	12	80	88	4
P44	tg. 10x200-400	10	200	400	2
P45	tg. 12x216-380	12	216	380	2
P46	tg. 10x216-225	10	216	225	4
P47	tg. 10x126-225	10	126	225	4
TOTAL LAMINATE				1190.94	
electrozi+grund (5%)				59.55	
Total (kg)				1250.5	

PROTECTIA ANTICOROSIVA:
*Gradul si tipul de curatire conform GP 111-2004:

- 1) Felul mediului - urban
- 2) Indicativul mediului - T+FN
- 3) Grad de curatire minim - 4

*Agresivitatea mediului conform STAS 10128/86:

- 1) Felul mediului - urban
 - 2) Clasa de agresivitate a mediului - 2 m
- *Categorie de coroziune:
C3 (medie), zona urbana
- *Protectie minima:
1) grund: 1 strat - min. 40µm/strat
2) vopsea: 2 straturi - min. 40µm/strat

NOTE:

01. A se citi aceasta plansa impreuna cu plansele de arhitectura si instalatii si a se corela cu acestea;
02. Cota ±0.00 a constructiei este definita in planurile de arhitectura;
03. Cotele relative sunt date functie de cota ±0.00 definita la punctul 2;
04. La realizarea lucrarilor se va tine cont de normele de protectie, igiena si sanatatea muncii aflate in vigoare;

05. Sudurile ce se vor executa pe santier vor fi de tip continuu pe conturul elementelor;
06. Grosimile cordoanelor de sudura vor fi 0.7 x tmin.
07. Grosimea unui cordon de sudura nu va fi mai mic de 3mm.
08. Suprafetele metalice se vor proteja impotriva coroziunii conform calelor de sarcini.
09. Sudurile se vor executa pe toata lungimea de suprapunere a pieselor.
10. Diametrul gaurilor va fi mai mare cu 2mm decat diametrul surubului.

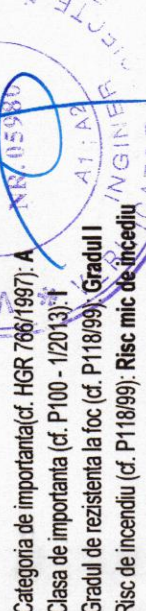

Nota:

1. Planurile de rezistenta se vor citi cu planurile de arhitectura si instalatii!
2. Toate planurile de fundatii se vor citi impreuna!

*Categorie de executie a elementelor conform STAS 767/0-88:
Categorie de executie - B
*Clasa de calitate oelului conform SREN 1993-1-10/2006:
Clasa de calitate - 2
*Calitatea imbinarilor sudate conform Normativ C 150-99:
Nivel de acceptare a imbinarilor sudate - B

MATERIALE - conf. SR EN 10025:2004:
a. S355J2 - bare laminate si table - structura principala
- limita de curgere minima fy = 355N/mm2;
- modulul de elasticitate E = 210000 N/mm2

b. Toate suruburile de prindere a ansamblurilor vor fi grupa 8.8



PROIECTANT GENERAL: ASOCIEREA		BENEFICIAR:	
BAU STARK S.R.L. Str. Iuliu Maniu, Nr. 35, Cluj-Napoca, Jud. Bihor, Sector 1, Romania Tel: 0366 300.100, Fax: 0366 300.101 E-mail: oficiu@bau-stark.ro Reg. Com. 25544/01/2016 CUI: RO 3887124		JUDETUL ARGES - SPITALUL DE URGENTA PITESTI	
MINIMED SOLUTIONS S.R.L. Str. Iuliu Maniu, Nr. 35, Cluj-Napoca, Jud. Bihor, Sector 1, Romania Tel: 0366 300.100, Fax: 0366 300.101 E-mail: oficiu@minimed.ro Reg. Com. 25544/01/2016 CUI: RO 3887124		DENUMIRE PROIECT:	
PROFESSIONAL TECH CONSTRUCT DESIGN S.R.L. (FOSTA HOSPITAL PROJECT & CONSULTING S.R.L.) Str. Iuliu Maniu, Nr. 35, Cluj-Napoca, Jud. Bihor, Sector 1, Romania Tel: 0366 300.100, Fax: 0366 300.101 E-mail: oficiu@protech.ro Reg. Com. 25544/01/2016 CUI: RO 3887124		EXTINDERE SI DOTARE SPATII DE URGENTA SI AMENAJARI INCINTA SPITALUL JUDETEAN DE URGENTA PITESTI	
HOSPITAL TECHNICAL SOLUTIONS S.R.L. Str. Iuliu Maniu, Nr. 35, Cluj-Napoca, Jud. Bihor, Sector 1, Romania Tel: 0366 300.100, Fax: 0366 300.101 E-mail: oficiu@hospital-tech.ro Reg. Com. 25544/01/2016 CUI: RO 3887124		ADRESA PROIECT: ALEEA SPITALULUI NR. 36, PITESTI	
PROIECTANT DE SPECIALITATE REZISTENTA:		TITLUL PLANSEI:	
BAU STARK S.R.L. Str. Iuliu Maniu, Nr. 35, Cluj-Napoca, Jud. Bihor, Sector 1, Romania Tel: 0366 300.100, Fax: 0366 300.101 E-mail: oficiu@bau-stark.ro Reg. Com. 25544/01/2016 CUI: RO 3887124		PROJECT NR. BSTK186	
SEF DE PROIECT		FAZA	
PROIECTAT		P.T. + D.E.	
PROIECTADESEMNAT		SPECIALITATEA REZISTENTA	
NUME		PLAN ANSAMBLU S1	
Arh. Eugen Banuta		SCARA	
Ing. Catalin Damian		1:20; 1:10	
Ing. Catalin Damian		DATA	
		REVIZIA	
		00	
		R 30	